

ONE OR MORE ROWS OF GARDMAT MAY BE REQUIRED AT PERIMETER - CONSULT HYDROTECH FOR PROJECT SPECIFIC REQUIREMENTS

ROLL FARTHEST FROM THE ROOF PERIMETER SHALL BE TUCKED UNDERNEATH ADJACENT ROLL WITH MIN.125 mm OVERLAP

EROSION CONTROL ZONE; WIDTH VARIES

VEGETATION FREE ZONE; WIDTH VARIES

PARAPET WALL

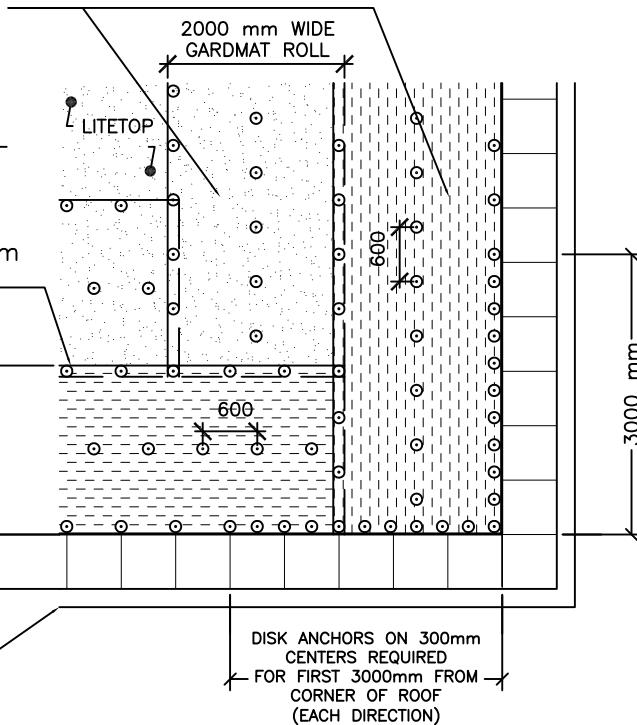

**LAYOUT AND ANCHORING**

**NOTE:**

- FOR SPECIFIC WIND UPLIFT REQUIREMENTS AND EROSION CONTROL SOLUTIONS, ALL PROJECTS MUST BE REVIEWED PRIOR TO BID BY HYDROTECH'S TECHNICAL SERVICE.



**GARDEN ROOF ASSEMBLY**

DISK ANCHOR AND GARDMAT EROSION BLANKET INSTALLATION

HYDROTECH MEMBRANE CORP.

NO SCALE

GAC-8A